

# MINED LAND

**A** story of environmental devastation and successful habitat restoration, the Mined Land Wildlife Area (MLWA) is located in Crawford, Cherokee, and Labette counties in southeast Kansas. Mining in the area began in the late 1800s.

Big Brutus, a twelve million pound electric coal shovel, remains near MLWA #44 as a reminder. Today, the area is characterized by woodlands, healthy grasslands, and abundant water.

The first land donation was

received in 1926. The largest acquisition, totalling 8,208 acres, was donated by the Pittsburg and Midway Coal Company to the Kansas Department of Wildlife, Parks and Tourism in 1981. The area includes 47 tracts totalling around 14,500 acres.

## FISHING

Several hundred water-filled pits dot the MLWA, creating about 1,500 acres of public waters. More than 200 lakes on the area are managed for fishing.

Strip-mine lakes produce some of Kansas' finest fishing. Sportfish include largemouth bass, rainbow trout, walleye, channel catfish, crappie, bluegill, redear sunfish, spotted bass, wipers, bullhead, and warmouth. Some lakes have been specially managed to favor certain fish species.

Special length and creel limits may be in effect for some fish species. Check the Kansas Fishing Regulations Summary and all posted notices before

## WILDLIFE

The Mined Land Wildlife Area has a diversity of habitats, including native grassland, woody shrub areas, oak-hickory forests, and wetlands.

Native grass establishments, timber stand improvement, food plots, and shrub planting continue to improve quail habitat. Cottontail rabbits and fox squirrels are abundant.

Several large food plots are managed specifically to attract doves in September. Doves can be abundant and offer good opportunities for all ages.

## OTHER OPPORTUNITIES

Photographers and wildlife observers will find a variety of birds and other animals at the MLWA.

A bison display herd is located on Unit 42 near West Mineral. Canoeing is allowed on all MLWA waters, while motorized boats may only be used for fishing and hunting. No water skiing or personal watercraft use is allowed.

The MLWA offers two modern rental cabins as an

alternative to tent and RV camping. The cabins are located on Unit 30 of the wildlife area overlooking the Trout Lake. The cabins are named Coal Ridge (west) and Mine 19 (east) to represent the coal mining era that once dominated this landscape. The cabins are available for rent year-round and will accommodate up to six overnight guests. For reservations go to: [www.reserve.ksoutdoors.com](http://www.reserve.ksoutdoors.com)

received in 1926. The largest acquisition, totalling 8,208 acres, was donated by the Pittsburg and Midway Coal Company to the Kansas Department of Wildlife, Parks and Tourism in 1981. The area includes 47 tracts totalling around 14,500 acres.

Waterfowl hunting can also be good on the area. Several marshes have been constructed to attract ducks. A waterfowl refuge often holds several hundred Canada geese in the area.

The woodlands areas of the property hold good populations of white-tailed deer and eastern turkey.

The area supports good numbers of raccoons, muskrats, bobcats, beavers, and coyotes. Other furbearers, including mink, and fox are also common.

alternative to tent and RV camping. The cabins are located on Unit 30 of the wildlife area overlooking the Trout Lake. The cabins are named Coal Ridge (west) and Mine 19 (east) to represent the coal mining era that once dominated this landscape. The cabins are available for rent year-round and will accommodate up to six overnight guests. For reservations go to: [www.reserve.ksoutdoors.com](http://www.reserve.ksoutdoors.com)

## THINGS TO REMEMBER

Vehicles are restricted to maintained roads and parking areas. Some roads are closed to all traffic. Do not leave vehicles parked on boat ramps. Use caution when launching boats because ramps drop off sharply, and trailers backed too far may become high-centered. Boat ramps are available on most large lakes.

Swimming is NOT allowed on the area.

Many of the lakes are steep sided, Anglers wading the shorelines should use caution.

Tent camping is allowed at any location except refuge areas. RVs may be parked in designated areas or parking lots. RVs may not block boat ramps, restrict road traffic, or drive off roads. No hookups are available.

Visitors must take their trash with them. Check the Kansas Fishing Regulations Summary and all posted notices before fishing.

Certain areas may be closed to hunting and fishing periodically.

Target shooting, trotlines and setlines are prohibited on all areas.

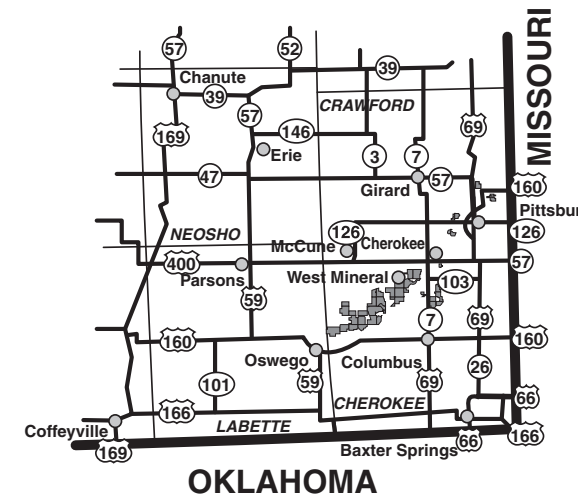

## General Area Map

Equal opportunity to participate in and benefit from programs described herein is available to all individuals without regard to race, color, national origin, sex, age, disability, sexual orientation, gender identity, political affiliation, and military or veteran status. Complaints of discrimination should be sent to Office of the Secretary, Kansas Department of Wildlife, Parks and Tourism, 1020 S Kansas Ave., Topeka, KS 66612-1327. 09/14

# Mined Land Wildlife Area

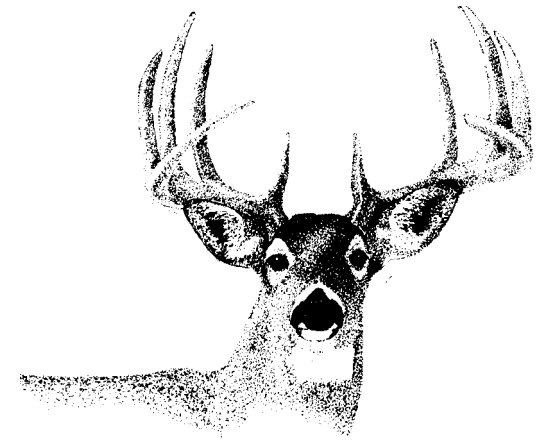

Mined Land Wildlife Area  
507 E 560th Ave.  
Pittsburg, KS 66762

(Area Office)  
(620) 231-3173

(Field Office)  
(620) 827-6301

(Regional Office)  
(620) 431-0380

  
Kansas  
Department of Wildlife, Parks  
and Tourism

[www.ksoutdoors.com](http://www.ksoutdoors.com)

# MINED LAND WILDLIFE AREA (SCAMMON UNITS)

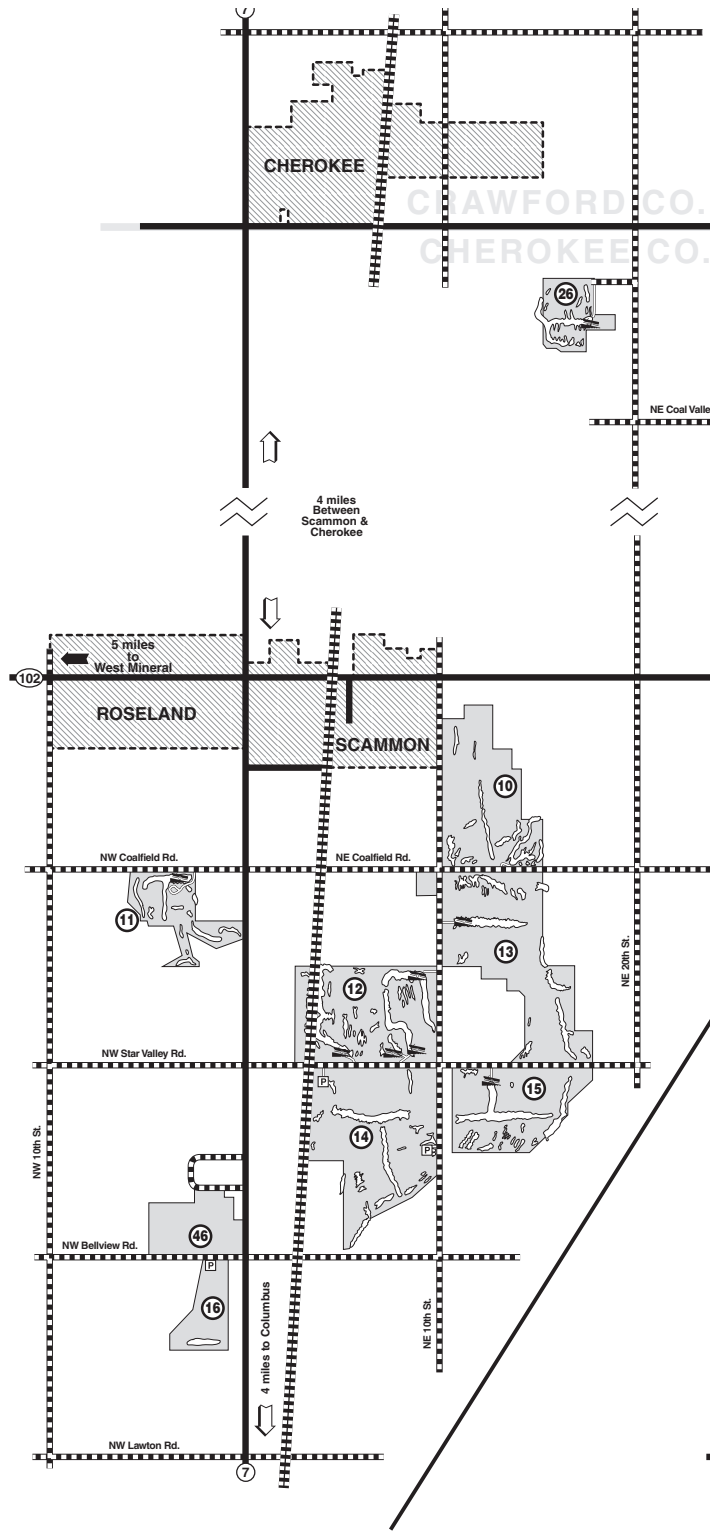

CRAWFORD CO.  
CHEROKEE CO.



# MINED LAND WILDLIFE AREA (PITTSBURG UNITS) Crawford County

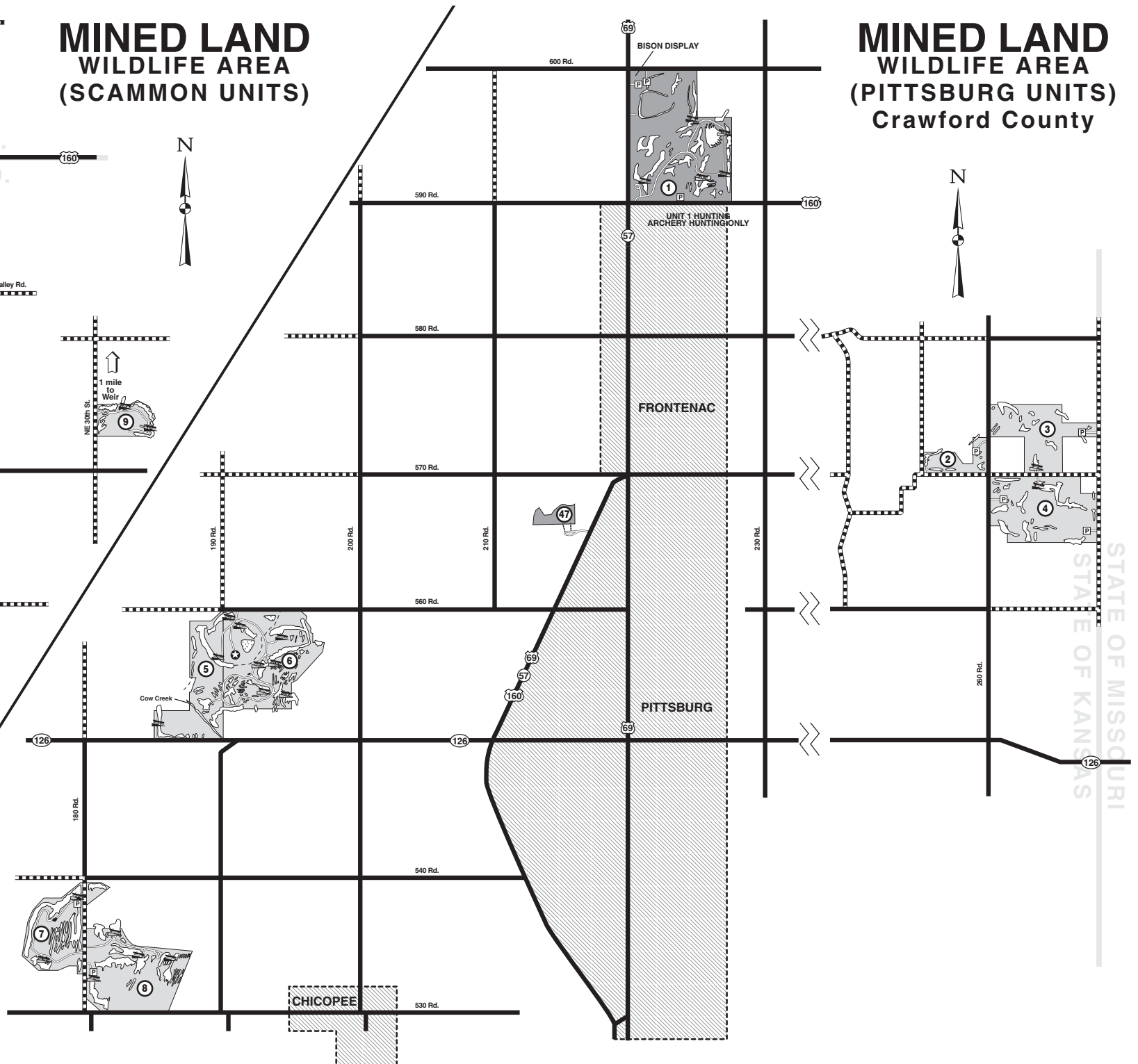

STATE OF MISSOURI  
STATE OF KANSAS

# MINED LAND WILDLIFE AREA (WEST MINERAL UNITS)

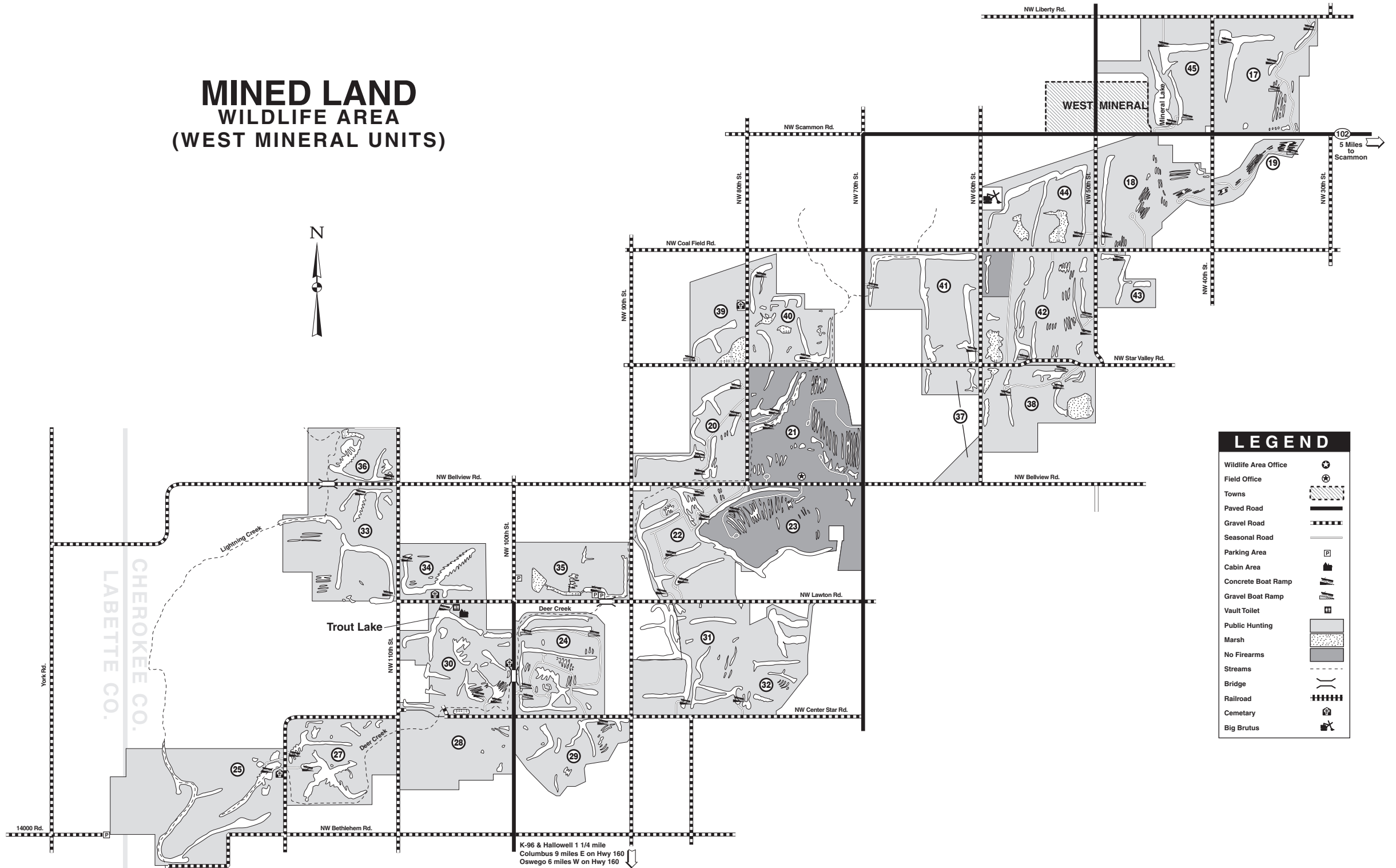

## LEGEND

- Wildlife Area Office
- Field Office
- Towns
- Paved Road
- Gravel Road
- Seasonal Road
- Parking Area
- Cabin Area
- Concrete Boat Ramp
- Gravel Boat Ramp
- Vault Toilet
- Public Hunting
- Marsh
- No Firearms
- Streams
- Bridge
- Railroad
- Cemetary
- Big Brutus

K-96 & Hallowell 1 1/4 mile  
Columbus 9 miles E on Hwy 160  
Oswego 6 miles W on Hwy 160